

Ref No:	TSM ecobug	Issue	1.4	Date:	3/2014
Subject:	<b>Ecobug Bio Friendly Caps &amp; Cleaning Regime – Washrooms</b>				
Customer:	Washroom Customers				
Comments:	Washrooms primary male, secondary female				

## Overview:

This TSM is to aid understanding of the ideal set up and ongoing monitoring and cleaning regime to be applied to ensure the most effective results from ecobug to improve sustainability and the environment primarily for the male urinals. A solenoid timer valve which will allow restriction of water flow needs to be installed together with the deployment of unique urinal caps. In conjunction with the urinal caps a strict bio cleaning regime needs to be followed by using a bespoke harmless concentrate that will ensure that the flush cycles will be reduced by circa 98%.

The urinal caps contains a formula of beneficial, harmless strain of bacteria which are concentrated into a pre-formed block which is inserted into a special cap cover containing holes, allowing the urine to make contact and gradually release the good bacteria. The bacteria grow extremely quickly in the drain environment, out-competing any harmful organisms (referred to as pathogenic bacteria) for available food sources. The growth of the beneficial bacteria will therefore suppress the development of harmful bacteria.

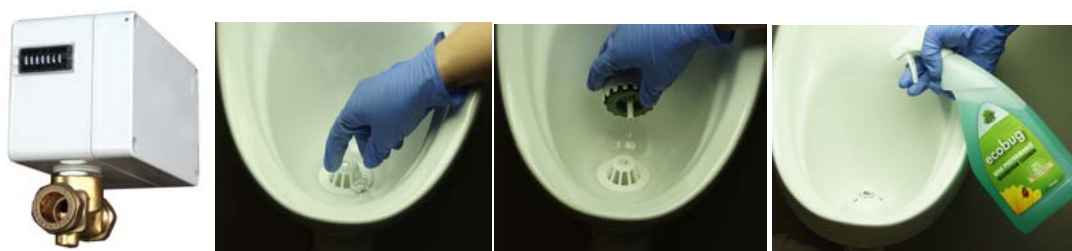

The urinal caps are designed either as a flat, domed cap dependent on which urinal drain strain is within your urinals. Please ensure you review and notify correct type when ordering, note for open cast drains we have a sucker adaptor or mat available. Ecobug system is used to not only aid water conservation but to place emphasis on maintenance of drains so they are kept blockage free. By management of uric acid and ammonia, smells can be contained. The product itself has a pleasant, clean and fresh smell, thus improving the ambiance of the washroom environment.

## Urinal Cap Implementation

- Initial set up;** requires installation of the ecobug solenoid valve to restrict the water flow to the urinals; you will require one per urinal cistern. Ideally each urinal should be changed over to a flat drain strainer however we do have indented caps for raised dome drain strainers..
- The caps are designed so their centre stem is placed in the centre hole of the drain strainer of each urinal, please be aware that due to usage variance with urinals the caps will need to be monitored on a weekly basis by simply lifting when cleaning around the drain strainer to review how much bacterial block is remaining and change when used up. It is likely the caps will last 2-4 weeks before requiring change. **Always handle with protective gloves. PLEASE ENSURE YOU ORDER THE CORRECT CAP FOR YOUR DRAIN STRAINER**



Flat Drain Cap

Raised Dome Cap

Sucker Base or mat for Open Drain Urinals

Ref No:	TSM ecobug	Issue	1.3	Date:	3/2014
Subject:	<b>Ecobug Bio Friendly Caps &amp; Cleaning Regime – Washrooms</b>				

## Cleaning Instructions

The use of the ecobug® High Performance Washroom Cleaner (eHPWC) is designed as a compliment to the caps and will **always** be used as part of the toilet cleaning regime. Available in 5 or 1 litre concentrate, each will be supplied with a 750ml hand spray gun(s) to dilute into. (approximately 133 refills per 1 x litre concentrate eHPWC).



**UNDER NO CIRCUMSTANCES MUST ANY DISINFECTANT OR BLEACH BE USED IN AND AROUND THE URINAL - ONLY eHPWC IS TO BE USED.**

1. eHPWC is to be diluted 100:1 which means a small amount of concentrate will go a long way. If your washroom has a particular problem with hard water and lime scale, eHPWC is particularly good at removing in a higher concentrate form. Please read instructions.
2. Remove any debris from the urinal, thoroughly clean with the eHPWC, place cap into grate by pushing into place as illustrated.
3. Each clean should use approximately 8 sprays in and around each urinal and wipe clean. Do not use other brands of disinfectant or any bleach as these will reduce the efficiency of bio bacterial to keep away bad smells and the drains clear.
4. Never pour waste water down the urinals

## Safe Disposal of used kit

All the products are made from natural ingredients as a bio friendly range of environmental products for the washroom cleaning regime – disposal of used caps should be handled in a similar manner to the sanitary waste from the ladies toilets



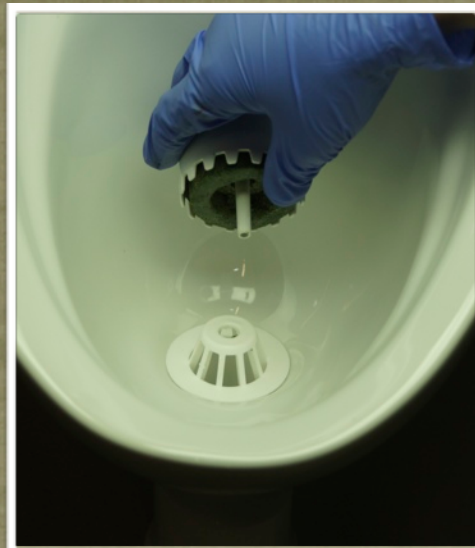

As part of the cleaning regime the ecobug cap should be lifted and a check on bacterial block remaining can be easily seen. Do not change until finished, each urinal will vary and will need checking on a weekly basis.



# ECOBUG PROCEDURES

## easy set up - monitoring cap usage and cleaning regime

Once set up it is a simple process of cleaning around the urinal and lifting the cap to check that bacterial block is not fully used. Use the ecobug High Performance Washroom Cleaner with a 100:1 dilution. Spray at least 8 times in and around the urinal remembering to lift and clean under the cap and around the flat drain strainer before placing back in the centre hole.

If problems of limescale are experienced use of the undiluted concentrate can be applied to limescale area, left for a period of 10-15mins before scrubbing off. Please ensure protective gloves are worn at all times.